

THE ENGINE & INTERIOR

DRIVER'S SEAT

Constructing the **DRIVER'S SEAT** of your Aston Martin DB5 model.

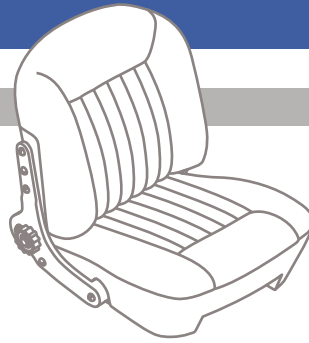

THE PARTS YOU WILL NEED:

- 002-A** : Driver's seat cushion
- 002-B** : Driver's seat base
- 002-C** : Driver's seat back
- 002-D** : Driver's seat back cover
- 002-E** : Driver's seat right arm
- 002-F** : Driver's seat left arm
- 007-A** : Seat adjuster
- SCREWS** : Type J (x2)

NOTE: Parts not shown to scale.

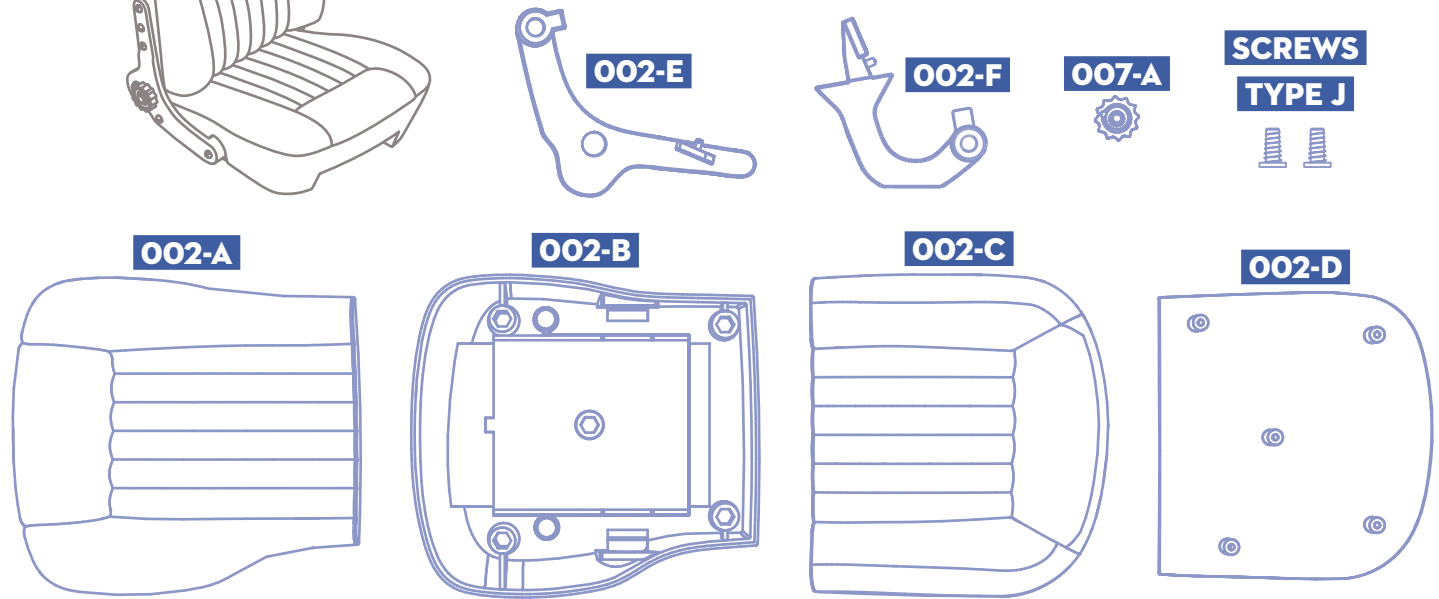

STEP 1

PARTS: **002-B**, **002-F**

Carefully thread the driver's seat left arm (**002-F**) through the gap on the left side of the driver's seat base (**002-B**).

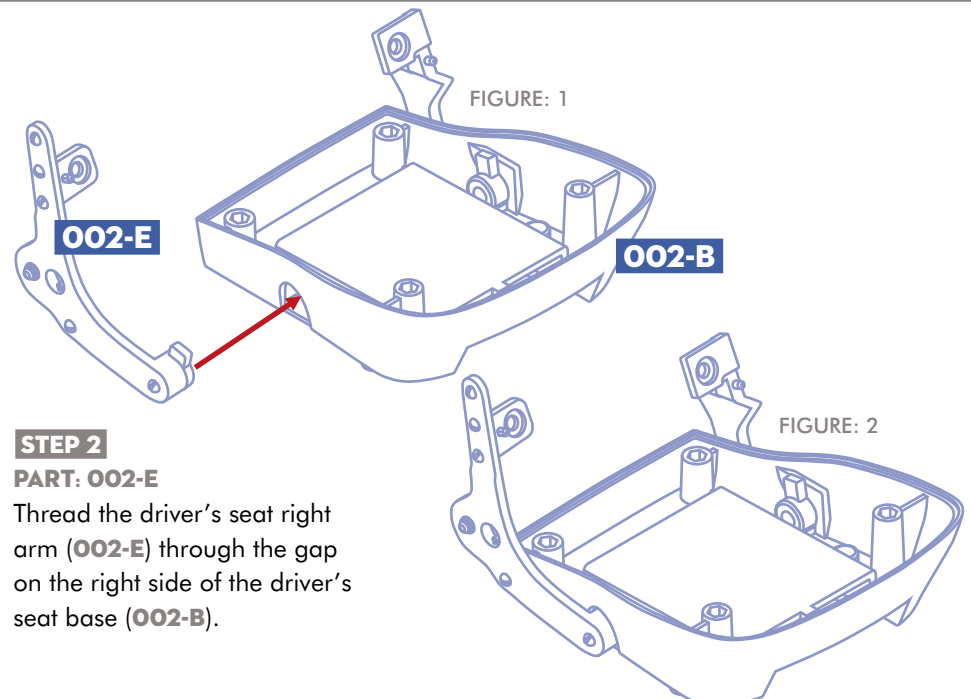
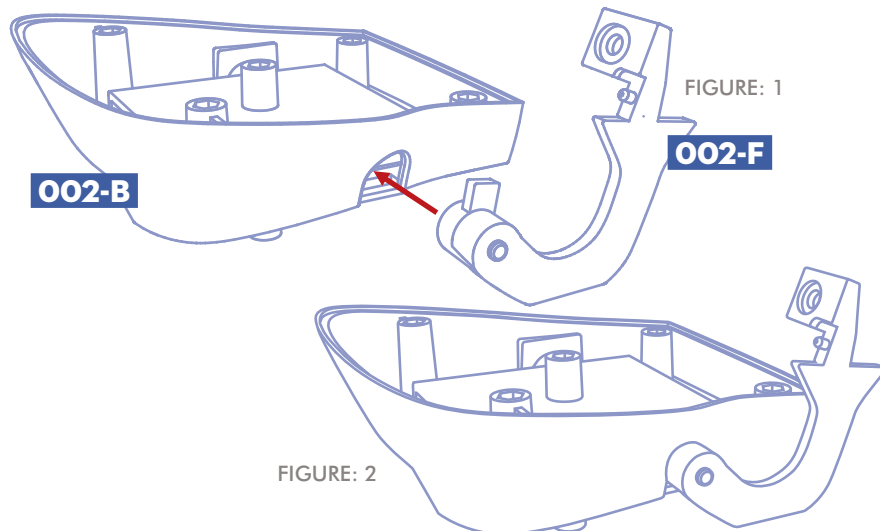

STEP 2

PART: **002-E**

Thread the driver's seat right arm (**002-E**) through the gap on the right side of the driver's seat base (**002-B**).

THE ENGINE & INTERIOR

DRIVER'S SEAT

Constructing the **DRIVER'S SEAT** of your Aston Martin DB5 model.

STEP 3

PART: 002-A

Fix the top of the driver's seat (**002-A**) to the driver's seat base (**002-B**) so that the base of each arm is covered.

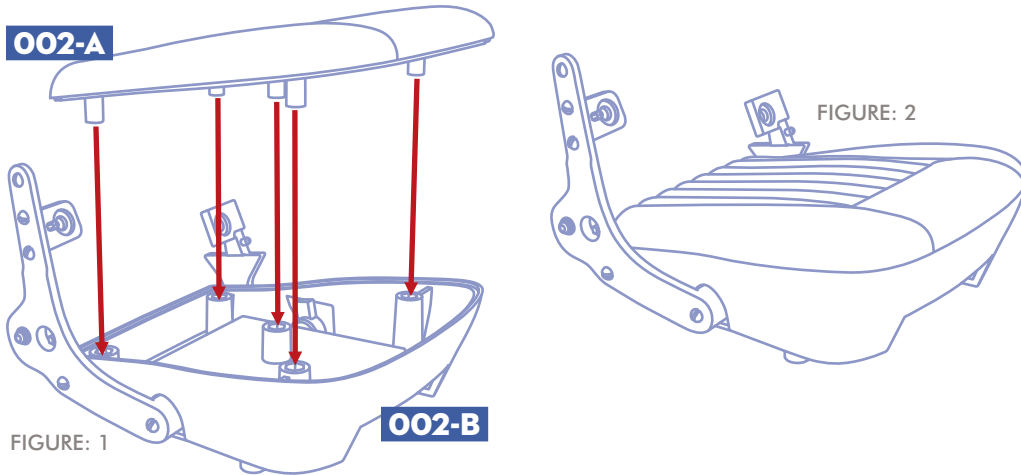

STEP 4

PART: 002-C

Clip the tabs of each arm (**002-E**, **002-F**) into the back of the driver's seat (**002-C**). Use two Type J screws to fix them together.

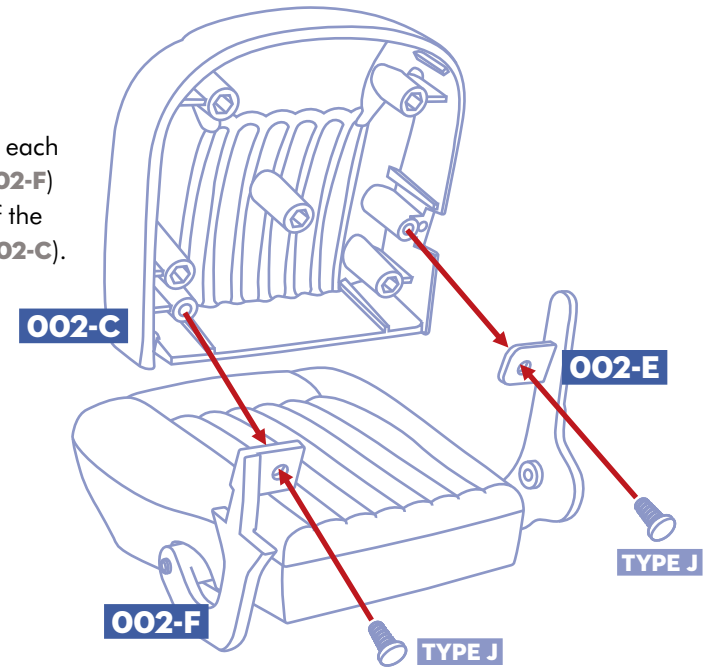

STEP 5

PART: 002-D

Push the driver's seat back cover (**002-D**) firmly into the rear of the seat.

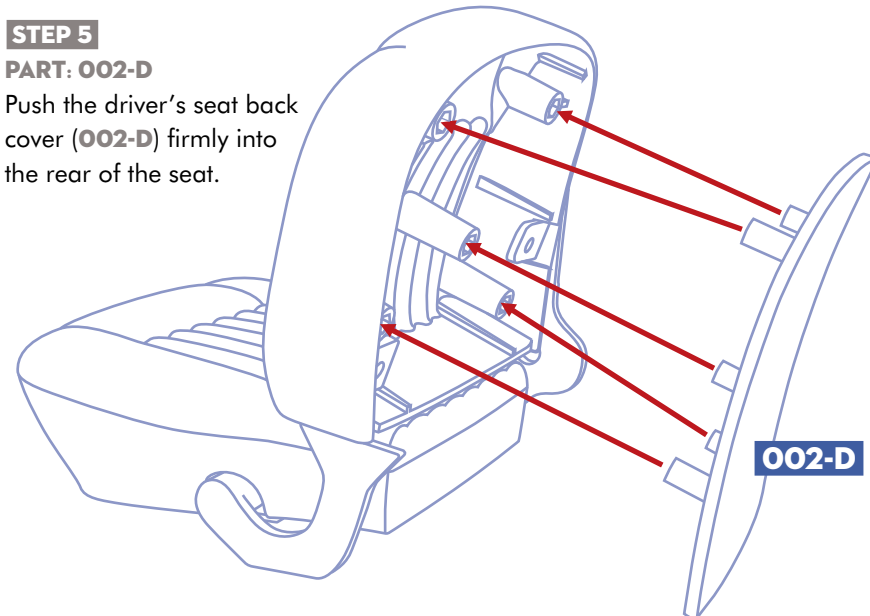

STEP 6

PART: 007-A

Clip the seat adjuster (**007-A**) to the left arm. There is a receiver and a peg for it to attach to.

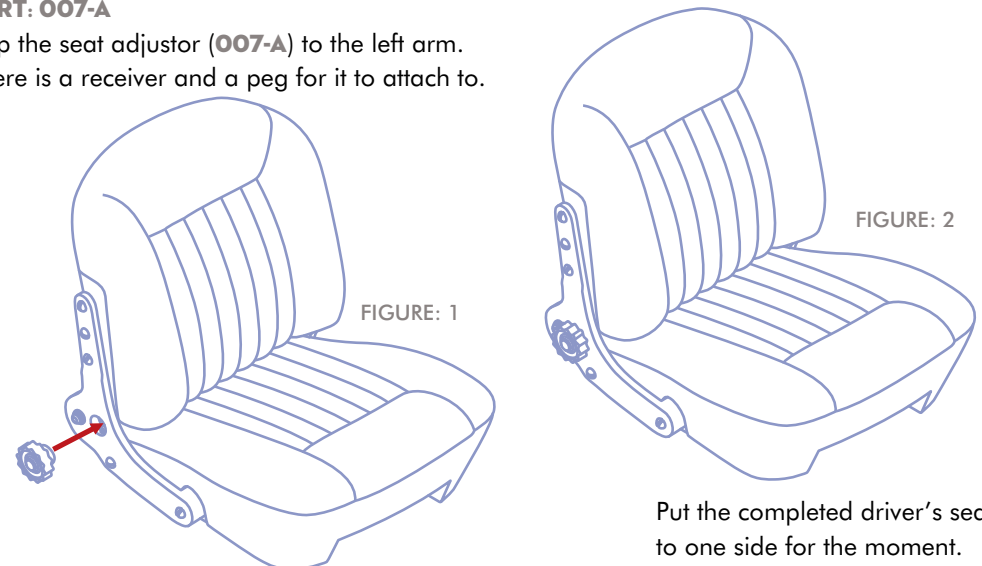

Put the completed driver's seat to one side for the moment.