

THE ROOF AND REAR

Constructing the **REAR WINGS** of your Aston Martin DB5 model.

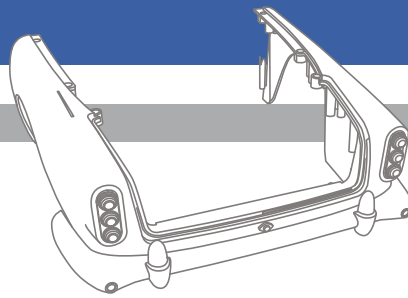

TAILLIGHTS

THE PARTS YOU WILL NEED:

069-A Right taillights, housing and electronic parts

070-A Left taillights, housing and electronic parts

071-A Rear wings section

SCREWS Type C (x2)

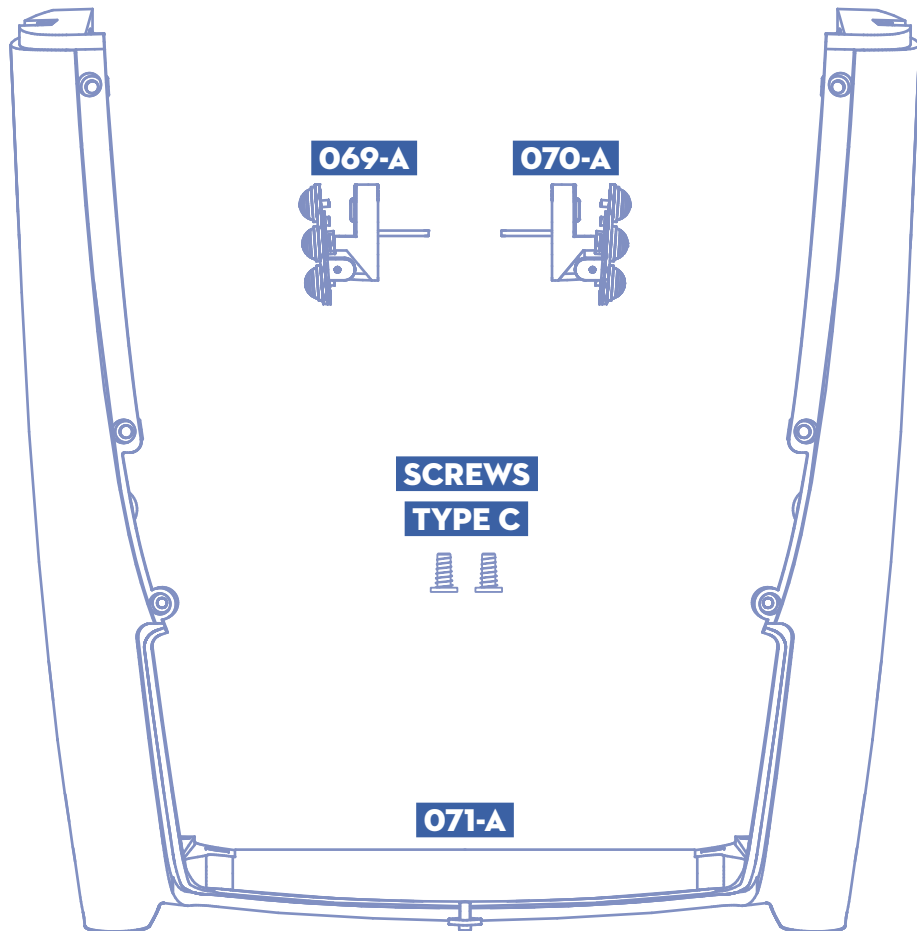

STEP 1

PARTS: 069-A, 070-A, 071-A

Feed the electronic leads (not shown) from the taillights through the larger holes in the holders for the rear light mounts. Clip the light mounts into the holders. Turning the rear wings over, use one Type C screw to fix each light mount into the wings

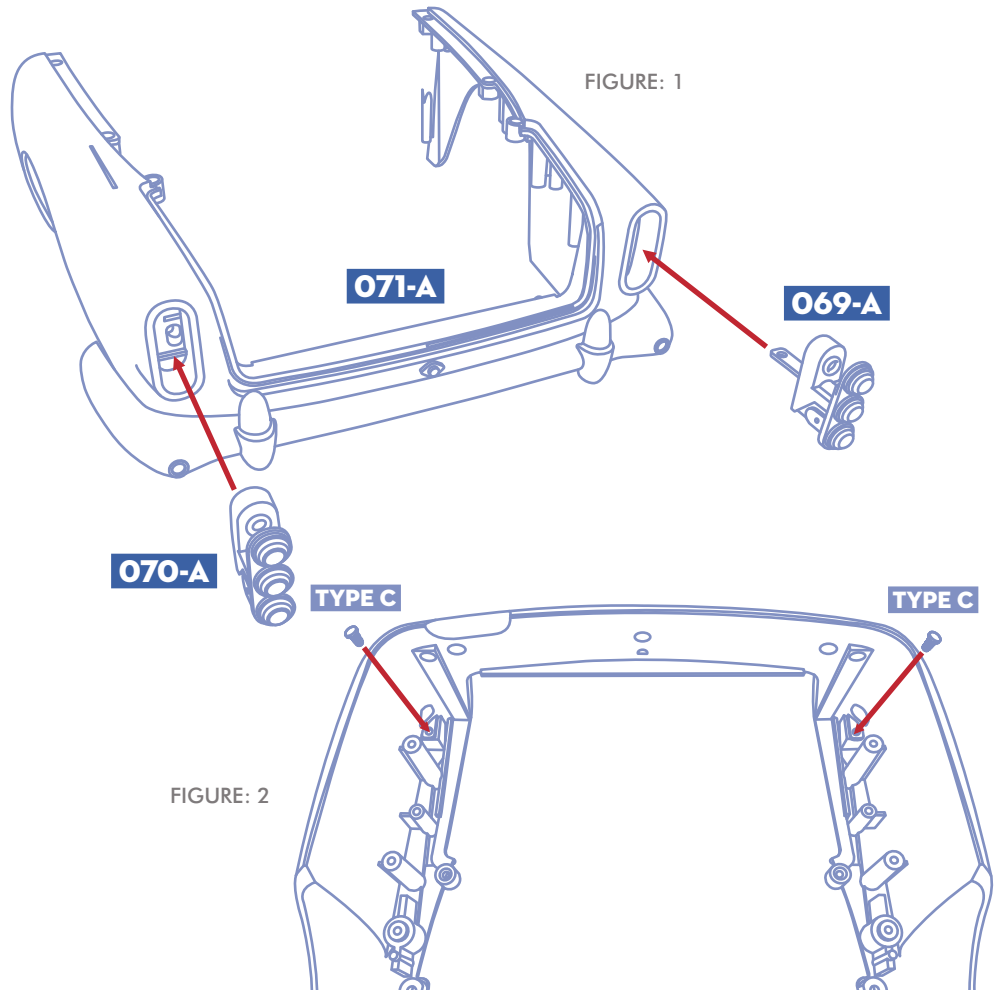

NOTE: Parts not shown to scale. Wiring not shown

Put this section to one side for the moment.