

ADDING THE CHASSIS

REAR WHEELS

Constructing the **REAR WHEELS** of your Aston Martin DB5 model.

THE PARTS YOU WILL NEED:

- 061-A** : Left rear tyre
- 062-A** : Left rear wheel
- 063-A** : Rear axle
- 063-B** : Rear axle back
- 063-C** : Supporting linkage
- 063-D** : Supporting linkage
- 063-E** : Supporting linkage
- 063-F** : Supporting linkage
- 064-A** : Trans shaft
- 065-A** : Right rear tyre
- 066-A** : Right rear wheel
- SCREWS** : Type E (x1), P (x4), W (x6)

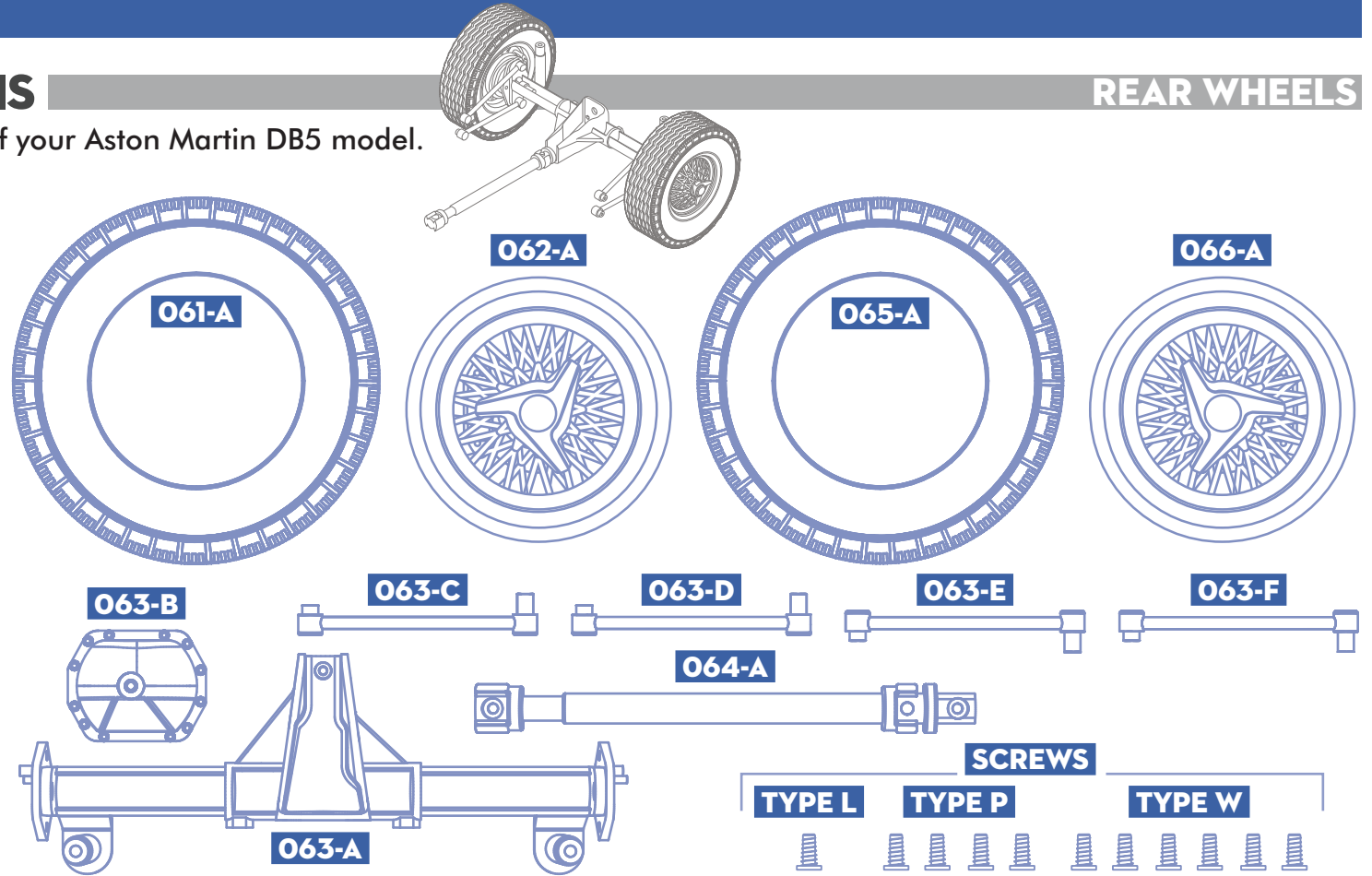

NOTE: Parts not shown to scale.

STEP 1

PARTS: 061-A, 062-A, 065-A, 066-A
Carefully fit the tyres (**061-A, 065-A**) over the pre-assembled wheels (**062-A, 066-A**).

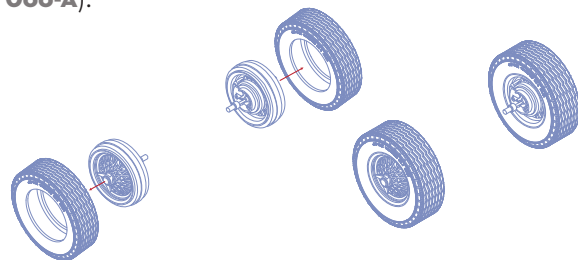

Put the wheels aside for the moment.

STEP 2

Place the four supporting linkages to each side of the rear axle, as shown. Make sure the longer peg on each linkage is the one that is fitted into the rear axle. Use four Type W screws to fasten into place.

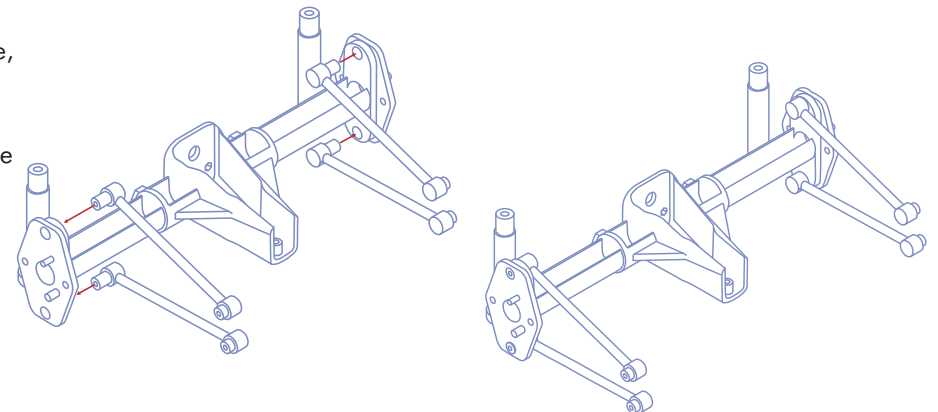

ADDING THE CHASSIS

REAR WHEELS

Constructing the **REAR WHEELS** of your Aston Martin DB5 model.

STEP 3

PARTS: 063-A, 063-B

Clip the rear axle back (**063-B**) to the rear axle, by lining up the two small pegs and fasten together with two Type W screws.

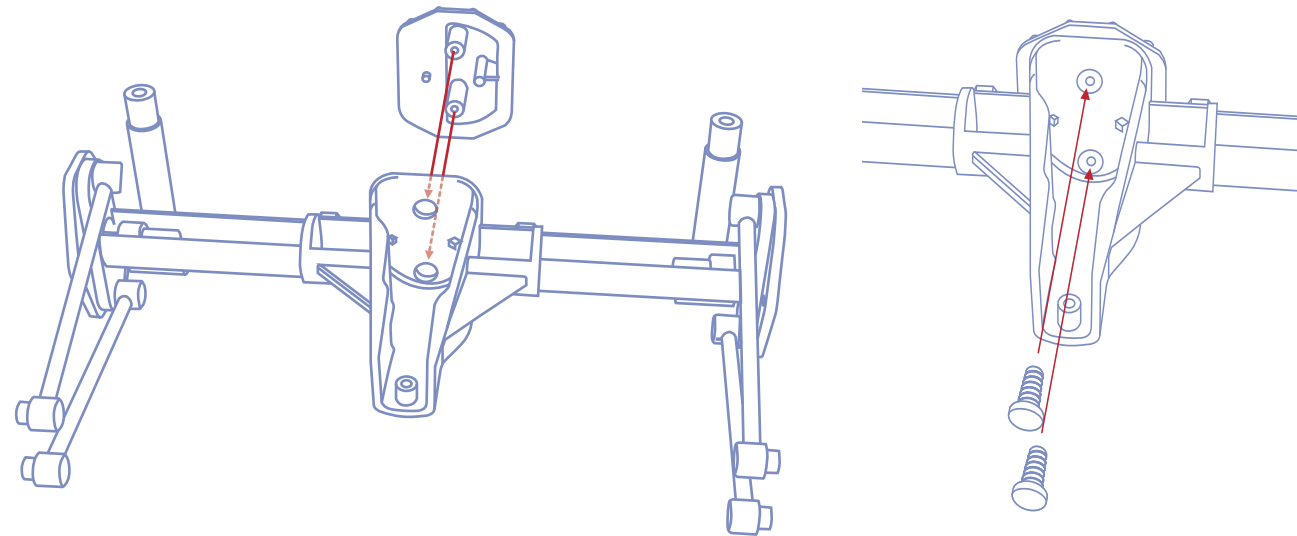

STEP 4

PARTS: COMPLETED WHEELS, 063-A

Attach the left and right rear wheels to each side of the assembled rear axle. There are two small pegs on each wheel. Line these up with the holes on the axle and push them together. The back of the tyre slasher will slide into the middle of the axle and the holes for the screws will line up. Finally, fasten each of the completed wheels to the axle with two Type P screws.

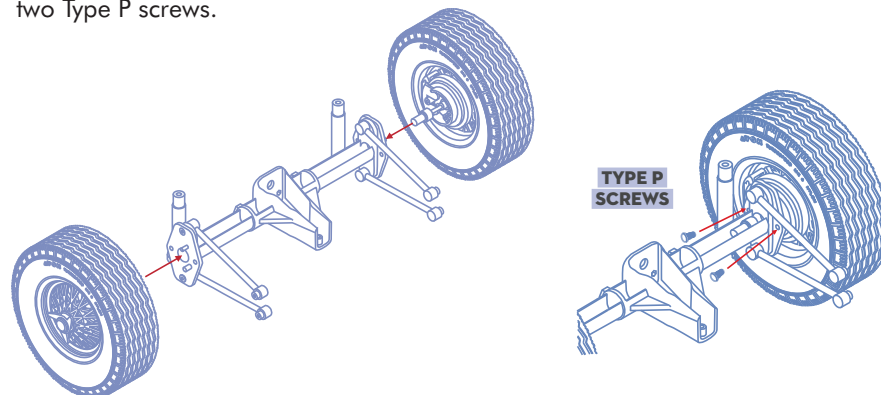

STEP 5

PARTS: 064-A

Connect the trans shaft (**064-A**) to the front of the rear axle, by lining up the long peg. Once in place, secure with a Type L screw.

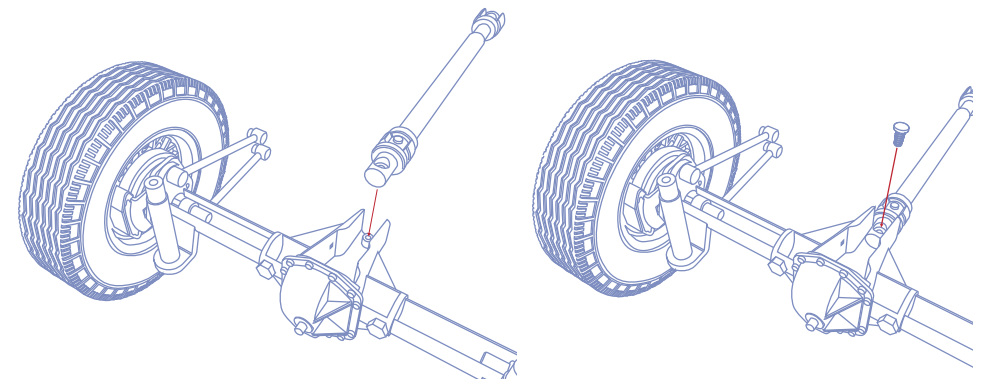

Put this section to one side for the moment.